



Steele-Waseca Coop Electric  
Coal Creek Tour-Bismarck, ND  
June 23-25, 2020

# REGISTRATION

1

**WHO'S COMING**  
(list first & last names; include age for students ages 10-18 yrs.; minimum age to participate on the trip is 10 years old)

- 1.
  - 2.
  - 3.
  - 4.
  - 5.
  - 6.
- List any special needs or notes:

## HOW DO WE REACH YOU

2

Address: \_\_\_\_\_  
City: \_\_\_\_\_  
Primary Phone: \_\_\_\_\_  
Mobile Phone: \_\_\_\_\_  
Email: \_\_\_\_\_  
SWCE Account #: \_\_\_\_\_  
Emergency Contact Name: \_\_\_\_\_  
Emergency Contact Phone: \_\_\_\_\_

## WHERE WILL YOU DEPART

3

(please circle one location)  
Steele-Waseca in Owatonna  
OR  
Flying J/Big Steer-Hwy 19

(we recommend getting on the bus in Owatonna)

## ACCOMODATIONS

- (please circle room type)
- a. 2 Queen Beds & 1 Pull Out Sleeper; (5 people)
- b. 2 Queen Beds-Handicap; (4 people)
- c. 1 King Bed & 1 Pull Out Sleeper; (3 people)
- d. 1 King Bed & 1 Pull Out Sleeper-2 Rooms; (3 people)

4

## TELL US HOW MANY ARE COMING

5

Members: \$310.00 each x \_\_\_\_\_ adults = \$ \_\_\_\_\_  
1-3 Students: FREE \_\_\_\_\_ FREE  
Add'l Students: \$150.00 each x \_\_\_\_\_ students = \$ \_\_\_\_\_  
Non Members: \$620.00 each x \_\_\_\_\_ people = \$ \_\_\_\_\_  
2nd Time Travelers: \$620.00 x \_\_\_\_\_ people = \$ \_\_\_\_\_  
(if you bring a first time member, then the price is \$310.00)

**TOTAL \$** \_\_\_\_\_**.00**

Signed: \_\_\_\_\_ Date: \_\_\_\_\_

## SEND IT IN

**Mail this form & payment to:**  
Steele-Waseca Coop Electric  
Attn: Jack Schwab  
2411 West Bridge St.  
P.O. Box 485  
Owatonna, MN 55060  
507-451-7340  
(email: jschwab@swce.coop)

6



the power of human connections

# sparks

Your Touchstone Energy® Cooperative

a monthly newsletter from Steele-Waseca Cooperative Electric

March 2020

## inside connections

- 2 Manager Connection
- 3 Guide to energy-efficient appliances
- 4 Cookin' Connection  
SWCE community solar update  
Sparks in brief  
Steele County Tip Line
- 5 Warning signs of overloaded outlets  
Air source heat pump operation  
Hometown Sampler  
Veterans Open Roundtable
- 6 Ad Connection  
4-Seasons Vacations
- 7 Ad Connection  
Steele-Waseca accepting auditions to sing national anthem at 84th annual meeting  
Remembering DeAnn Kaplan
- 8 Signup form for 2020 Coal Creek Tour

## calendar of events

### March

- 1 Final day of Community Pathways of Steele County Hometown Sampler at Little Theatre of Owatonna
- 2 Dr. Suess' birthday  
National Read Across America Day
- 3 "The Star-Spangled Banner" made U.S. national anthem in 1931
- 8 Daylight saving time starts
- 17 St. Patrick's Day
- 19 First day of spring

# Welcome Spring

## Construction underway on Faribault air separation plant

Courtesy: Great River Energy; plant to be powered by Steele-Waseca Cooperative Electric

Construction is underway in Faribault on an independently owned and operated air separation plant that will be powered by reliable electric service from Steele-Waseca Cooperative Electric (SWCE), one of Great River Energy's (GRE's) 28 member-owner cooperatives.

Absolute Air—a consortium of five independent gas and welding supply distributors along with the Independent Welding Distributors Cooperative—will bring gases often used in the medical, electronic, food packaging, laboratory and metal fabrication industries to the Upper Midwest region beginning sometime in early 2021. Together, the consortium represents 30 business locations with more than 50,000 customers in a seven-state region.

"Now we're going to be making a bulk of those gases ourselves...It's kind of a disruption to the normal course of business, and the eyes of the industry are on us," said Brad Peterson of Mississippi Welders Supply, one of the five distributors that created Absolute Air, at the project's groundbreaking. "The big guys are watching to see if we stumble, and the little guys are watching to see if this is a replicable model that they can go out and reproduce. I think we're up to the challenge; we're ready."

Peterson said the plant is expected to be an economic driver for the region as many larger businesses seek out collocation opportunities "since these gases are so critical to their process."

The Northern Industrial Park site chosen by Absolute Air was identified after GRE Economic Development Services



Representatives from the companies that make up Absolute Air are pictured at the plant's groundbreaking event last year.

Manager Tom Lambrecht suggested Faribault as a location that would meet their needs. As a cooperative, GRE is committed to the sustainable development of communities served by its member-owners, and works with local and state organizations to assist businesses planning to locate or expand in these areas. The site, served by SWCE, ended up not only suiting the plant's infrastructure requirements but is also centrally-located for all five companies invested in the project. 26333

"It was very important to have good electrical power, get a good rate and [find] a good provider that has good reliability," Peterson said. "We're working with Steele-Waseca Cooperative Electric and Great River Energy. Thank you for being part of this."

Great River Energy is currently in the process of seeking approval from city officials to build a new substation and install new overhead transmission lines to help SWCE deliver the robust electric power needed to serve the plant.

**Steele-Waseca Cooperative Electric line crews in March and April will be conducting their yearly inspection of the co-op's power lines, including an in-depth inspection of their underground facilities. The co-op services the lines up to the meter pole at member service locations, so it may be necessary for Steele-Waseca trucks to enter driveways during line inspections. The yearly check is mandated by the co-op's insurance provider. Thank you for your cooperation.**





## cookin' connection

### Garlic Seasoned Baked Pork Chops

Christy Strobel

Kilkenny

2 Tbsp butter; melted  
1 egg; beaten  
1 pinch garlic powder (or to taste)  
1 pinch seasoned salt (Lawry's; or to taste)

2 Tbsp milk  
pork chops

Preheat oven to 425°. Pour butter into a 9x13" baking dish, tilting to cover entire bottom of dish. Whisk egg and milk together in shallow bowl; dip pork chops into egg mixture. Transfer pork chops to the baking dish. Sprinkle pork chops with garlic powder and seasoned salt. Bake pork chops in preheated oven for 10 minutes, then flip chops and season the other side with garlic powder and seasoned salt. Cook until chops are no longer pink in the center, about 10 more minutes. An instant read thermometer should read at least 145°.

Please use a 3 x 5 card when submitting your recipe. The member whose recipe is published will receive a \$7 energy credit.



Steele-Waseca Cooperative Electric's solar subscribers will see a 10 kWh credit per panel on this month's statement for energy generated during January 2020. Learn more about community solar and The Sunna Project by visiting Steele-Waseca's website, [swce.coop](http://swce.coop).

## Was your account number in Sparks?

Each month five account numbers are printed in *Sparks* and a total of \$35 in energy credits is divided among however many of those numbers are found. For example, if all numbers are found, a credit of \$7 will be applied to the members' following month's electric bills; or, if only one number is found, that member receives the full \$35 credit. Members finding their numbers who have a load management receiver on their dual fuel, electric water heater, air conditioner, or genset will receive an additional \$7 credit. When you find your number, phone our office no later than the 7th of the month following receipt of the *Sparks*, or the amount will be forfeited. 1021676

## February issue of Sparks



**Numbers found:**  
None by those members

**Numbers not found:**  
Daniel Thofson  
Allan/Doreen Nelson  
Michael/Belinda Isaacson  
Joshua Abbe  
Melissa/Adriaan Erasmus



sparks • march 2020

## Sparks in brief . . .

• **Want easy energy payments?** Sign up for **EnergyPay Plus**, our automatic payment plan, or **Energy Prepay**, our discounted advance payment plan. Contact our office for details. You may also pay your bill online at [www.swce.coop](http://www.swce.coop). By entering your Steele-Waseca username and password you can also view a 13-month history of your account.

• **If you have changed or added phone numbers**, please contact SWCE to update your contact information.

• **Need a new water heater?** For information about our Westinghouse Electric Water Heater Program, phone Cindy Butterfield at our office between 8 a.m.-3:30 p.m., 446-4204 / 800-526-3514.

• **January temps** – The average high temperature for January was 25° F, while the average low was 12° F. This resulted in 1,428.5 Heating Degree Days (HDDs), and 0 Cooling Degree Days (CDDs). They compare to last year's average high of 21° F and average low of 5° F. This resulted in 1,616.5 HDDs and 0 CDDs.

• **ENERGY STAR® Rebates** – In 2020, all ENERGY STAR refrigerators/freezers (with recycling), electric clothes dryers, dehumidifiers, central air conditioners, air and ground source heat pumps, light emitting diode (LED) bulbs purchased (limit 5) are eligible to receive rebates (may not be combined with special promotions). Rebate request forms must be submitted within 90 days of purchase. Rebate forms are available at [www.swce.coop](http://www.swce.coop). For more information or to receive a rebate request form, phone Cindy Butterfield at 446-4204 or 800-526-3514.

• **Steele-Waseca's tree service contractor** – Carr's Tree Service, Inc., is contracted to do SWCE's tree trimming. To report a tree concern, phone:

**507-451-7340 / 800-526-3514**

### STEELE COUNTY TIP LINE

**866-878-7964**

TO BE USED TO REPORT ANY CRIME OR SUSPICIOUS ACTIVITY ANONYMOUSLY

COVERS ALL OF STEELE COUNTY INCLUDING THE CITIES OF:

**OWATONNA ELLENDALE  
BLOOMING PRAIRIE MEDFORD**

## health & safety connection

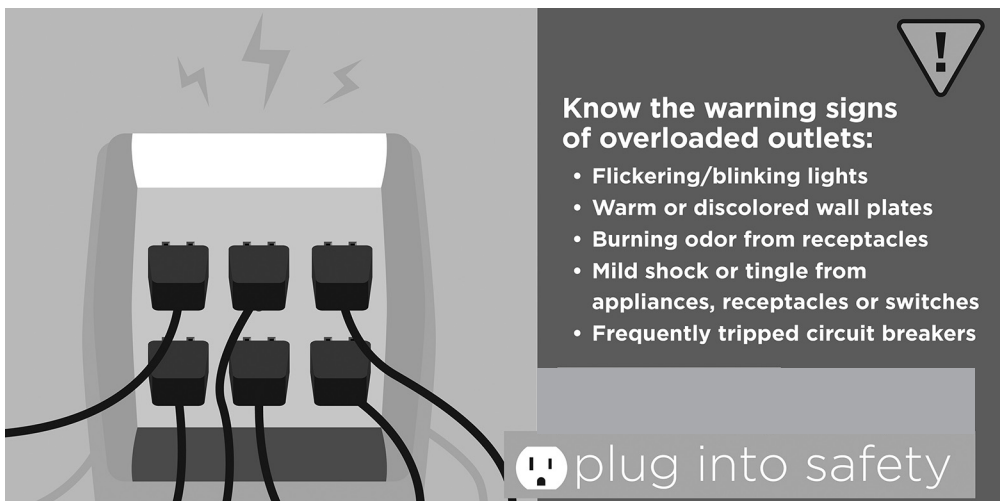

## Veterans Open Roundtable Schedule

**March 10, 2020.....George Lundstrom**  
*George's Navy Pilot basic training started in Pensacola, Fl in August 1967 and commissioned as Ensign in the US Navy, joined the Naval and Marine Officers from the Naval Academy, Officer Candidate School, and Naval ROTC, sent to Saufley Field for basic flight training in a T-34 mentor etc. Next Pensacola for air-to-air gunnery and carrier qualification training, then to Beeville, TX for advanced jet training, received wings, Miramar NAS, San Diego train to fly the F-8 Crusader. National Guard July 2009 – June 2013*

Good Shepherd Lutheran Church-  
Second Tuesday of the month  
February 2020 - June 2020 at 7:00pm

Programs can be viewed at  
[owatonnalive.com](http://owatonnalive.com)

sparks • march 2020

## How Do Air-Source Heat Pumps Work?

By transferring heat between a house and outside air, these devices trim electricity use by as much as 30 percent to 40 percent in moderate climates.

### SUMMER

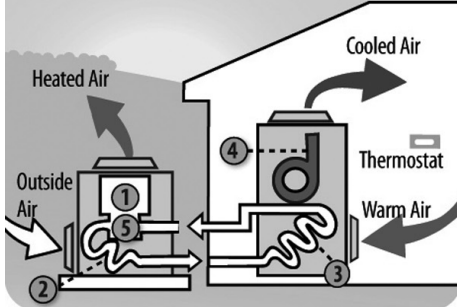

### WINTER

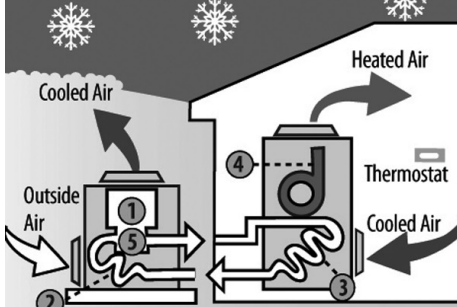

#### 1 Compressor

Increases refrigerant pressure to accept the maximum heat from the air.

#### 2 Condenser

Coils move refrigerant (and with it, hot or cold air) to or from outside air.

#### 3 Evaporator

Coils move refrigerant (and with it, hot or cold air) to or from outside air.

#### 4 Air Handler

Fan blows air into a home's ducts.

#### 5 Reversing Valve

Switches the direction of refrigerant flow, changing the heat pump's output to hot or cold air (controlled by thermostat).

Source: NRECA

5